

**LEGEND**

1. CONVERT EXISTING TENNIS COURTS TO ONE BASKETBALL COURT & ONE PICKLEBALL COURT. HEARD COUNTY TO DEMOLISH ASPHALT DOWN TO GRAVEL BASE. CONTRACTOR TO INSTALL 1 1/2" ASPHALT COURT. THE FOLLOWING TO BE BY HEARD COUNTY: FINISH SURFACE, STRIPING, NETS, GOALS & FENCES.
2. HEARD COUNTY TO DEMOLISH AND HAUL OFF EXISTING CONCRETE BASKETBALL COURT AND ASSOCIATED COMPONENTS AND MATERIALS. MATERIALS TO BE REMOVED DOWN TO BARE SOIL BELOW. NEW BASE AND SURFACE FOR PLAYGROUND TO BE BY PLAYGROUND EQUIPMENT INSTALLER.
3. INSTALL SLAB AND BELOW GRADE UTILITIES FOR INSTALLATION OF PREFABRICATED RESTROOM BY HEARD COUNTY. COORDINATE WITH SPECIFICATIONS FOR PREFABRICATED RESTROOMS. CONNECT PLUMBING AND ELECTRICAL SERVICES. EXISTING CONCESSIONS & RESTROOM BUILDING, SLAB & BASE TO BE DEMOLISHED BY HEARD COUNTY.
4. BASE PRICE TO ASSUME THAT HEARD COUNTY WILL INSTALL A NEW 10'-0" WIDE ASPHALT WALKWAY AND BASE. ALTERNATE NO. 1: CONTRACTOR TO INSTALL A 6'-0" WIDE 4" THICK CONCRETE WALKWAY.
5. CONTRACTOR TO INSTALL A NEW 6" DIAMETER SCHEDULE 40 PVC SANITARY SEWER LINE CONNECTING THE EXISTING PUMP STATION TO THE STUB OUTS FOR THE NEW RESTROOM FIXTURES. PIPE SHALL FOLLOW THE FALL AND DEPTH OF THE EXISTING PIPE. EXISTING PIPE SHALL BE ABANDONED AND LEFT IN PLACE. CAP AT EACH END.

1 PROPOSED SITE PLAN

RELEASED FOR CONSTRUCTION

Revisions		
No.	Date	Description
6/1/2021	ISSUE DATE	



**Gardner  
Spencer  
Smith &  
Tench &  
Jarbeau**  
A Professional Corporation  
for the Practice of Architecture  
www.gsstj.com  
60 Hurt Plaza SW,  
Suite 1100  
Atlanta, Georgia  
30303  
404.522.8805  
404.521.2118 (F)

PROJECT NO.  
20106

SHEET TITLE  
SITE PLAN

SHEET NO.

**AS1.00**

1" = 50'-0"

SEE NOTES ON SHEET AS1.00

HEARD COUNTY PARK

101 GLOVER ROAD  
FRANKLIN, GA  
30217

RELEASED FOR CONSTRUCTION		
Revisions		
No.	Date	Description
1	6/1/2021	ISSUE DATE

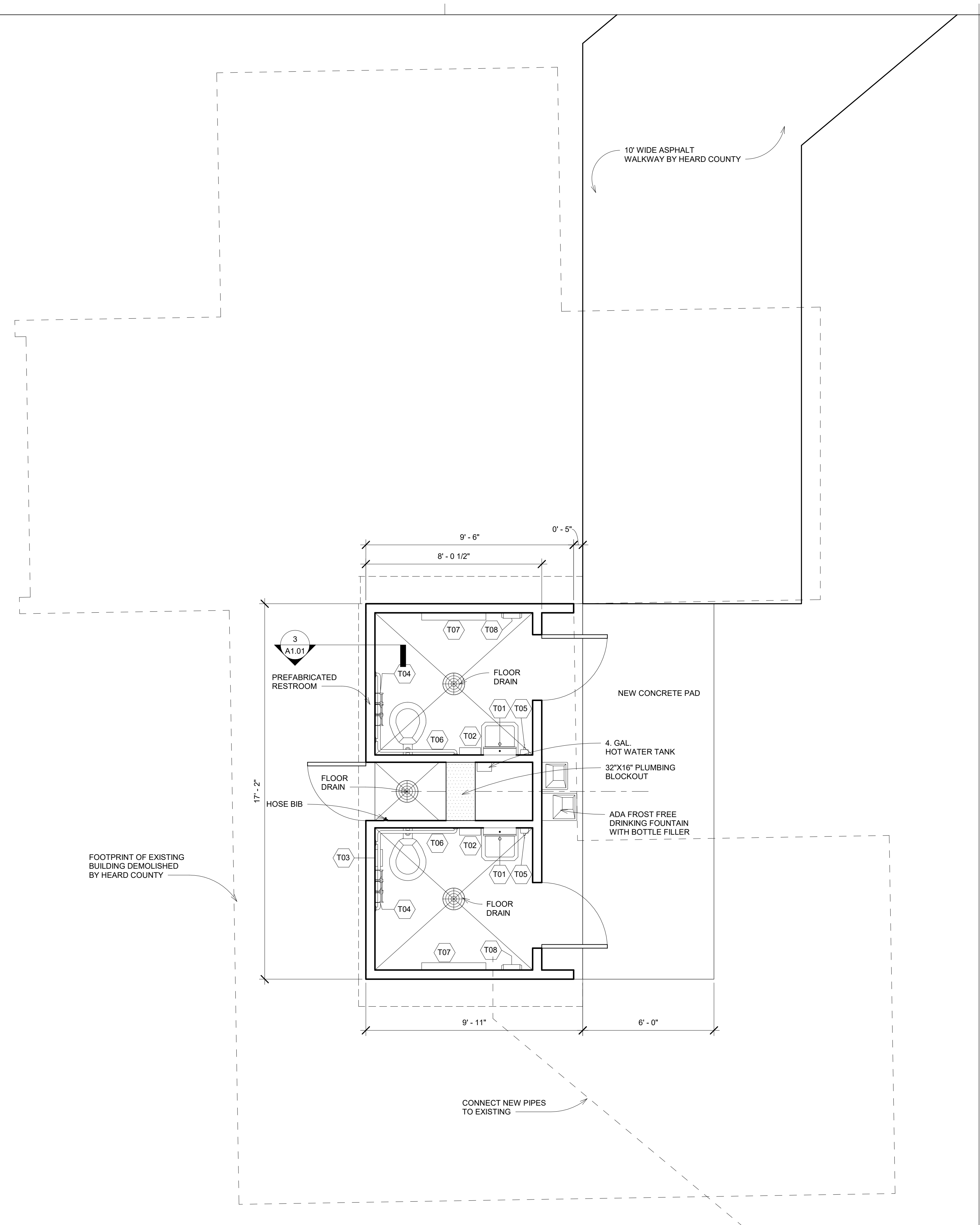

1 Enlarged Restroom Plan 3/8" = 1'-0"

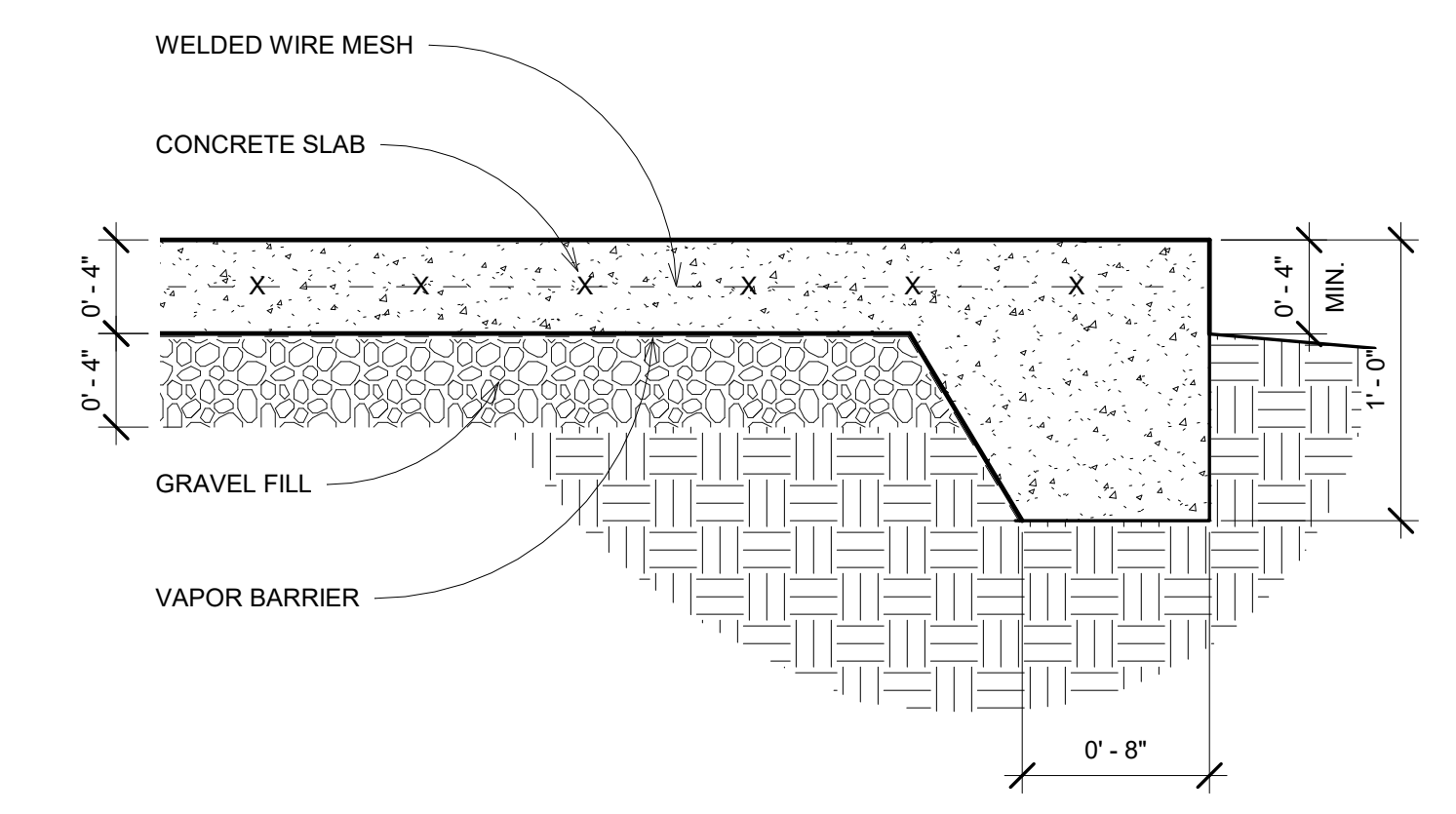

3 SLAB SECTION 1 1/2" = 1'-0"

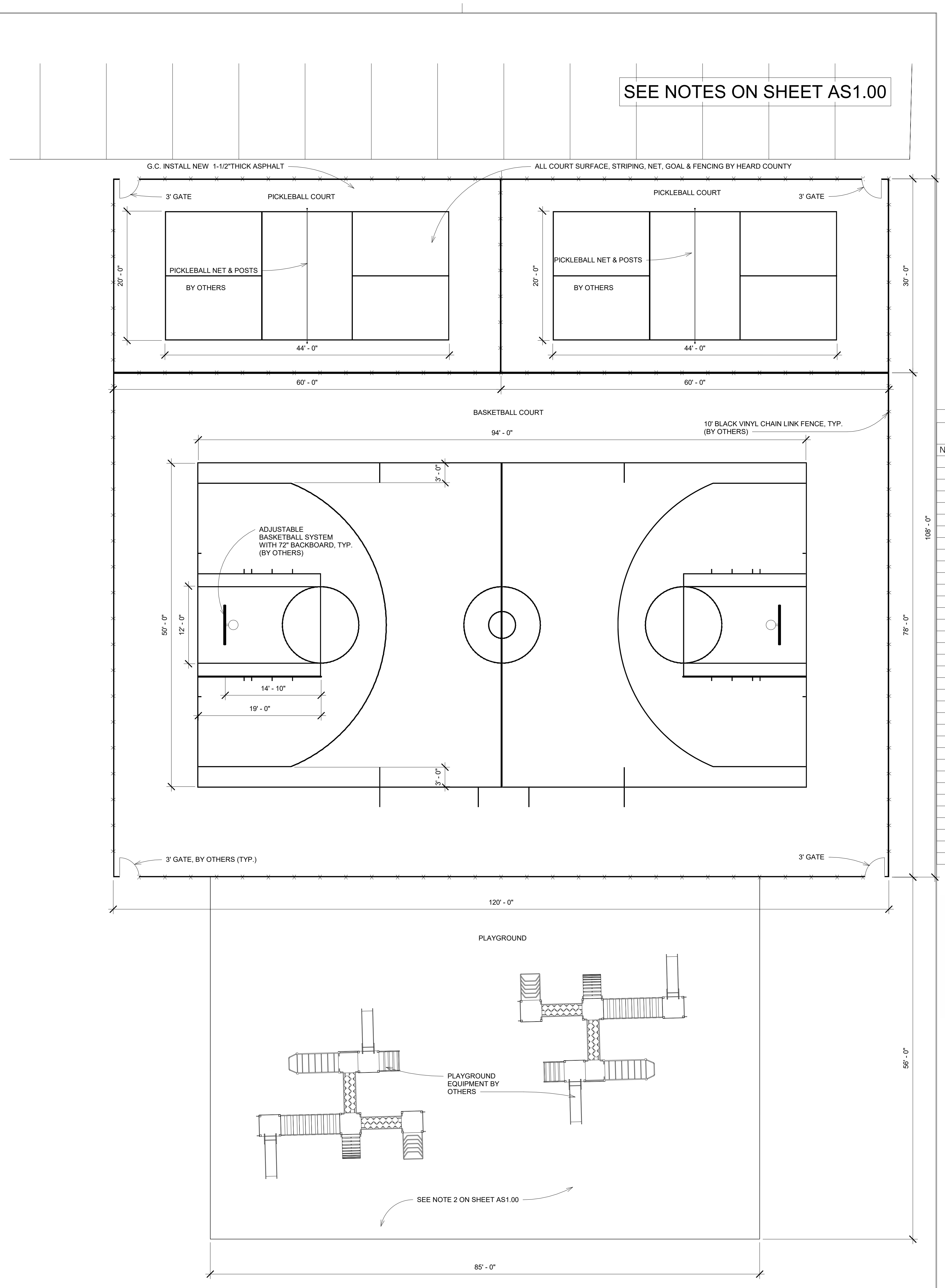

2 Enlarged Court Plan 1/8" = 1'-0"

**Gardner  
Spencer  
Smith  
&  
Jarbeau**  
 A Professional Corporation  
 for the Practice of Architecture  
 www.gsstj.com  
 50 Hurt Plaza SW,  
 Suite 1100  
 Atlanta, Georgia  
 30303  
 404.522.8805  
 404.521.2118 (F)

PROJECT NO.	20106
SHEET TITLE	Enlarged Site Plans
SHEET NO.	A1.01

© 2021 - THESE DOCUMENTS REMAIN THE PROPERTY OF THE ARCHITECT AND MAY NOT BE REPRODUCED WITHOUT WRITTEN PERMISSION.